

Section 20

CEJN Weo Plug-in Hydraulic Range

in this section.....

Weo Plug-in Fittings

522 - 525

WEO Plug-In is an entirely new type of coupling that will transform and simplify hydraulic systems that include hydraulic hoses and pipes. The couplings are self-locking, so there is no need for tools or spanners to connect or disconnect them. All that is needed is a simple screwdriver. This makes it easier to build more compact and reliable systems and designs, which is a major advantage since space is often very limited. The WEO Plug-In coupling also swivels freely, which eliminates the stresses that can arise during connection, and therefore extends the life of the hose. Quick and easy connection and disconnection also reduce oil spills, which is better for the environment.

WEO plug-In couplings are protected by patent. They have been tested by the Swedish Institute of Materials Testing and Research to SS-ISO 8032, half omega test. The working pressure for all couplings between 1/4" and 3/4" is 350 bar, while 1" couplings are rated at 250 bar. The working pressure may vary with the type of connection. A safety factor of at least 4:1 between burst pressure and working pressure applies to all sizes.

Specifications

Temperature range -30°C to +100°C (-22°F to +212°F)
short exposure +120°C (248°F)

Materials

Coupling body	Steel, yellow zinc chrome-plated
Nipple body	Hardened steel, yellow zinc chrome-plated
Catch	Hardened steel, yellow zinc chrome-plated
O-ring	NBR
Support ring	PUR
Unlocking-ring	POM
Stop-clip	POM

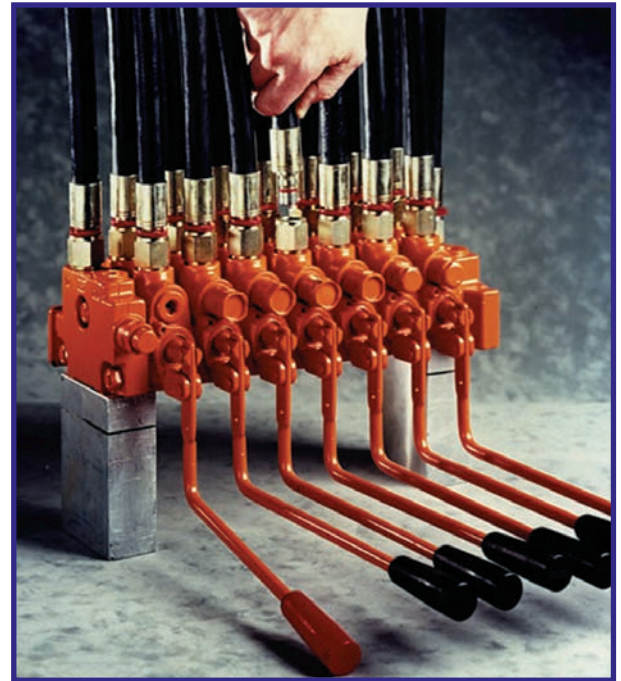

Simple yet ingenious, and with excellent development potential!

Easy to connect ...

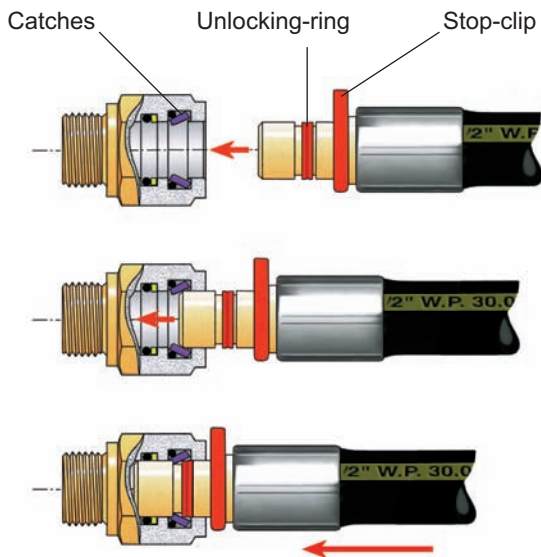

... and just as easy to disconnect

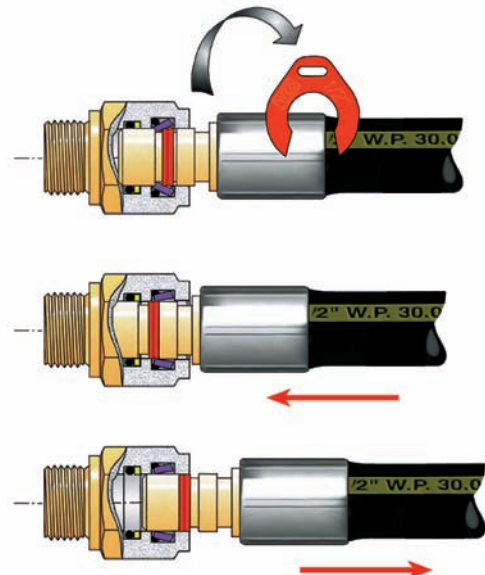

Check that the stop-clip is in place and that the unlocking-ring runs freely in its groove. The plug is pushed into the socket so that the catches are pressed outwards.

The plug is pushed all the way in until the stop-clip touches the socket. The O-ring presses the catches inwards so that they grip the locking flange on the plug. The coupling is now locked and cannot be disconnected.

The coupling is sealed by an internal O-ring.

The stop-clip is removed (using a screwdriver, for example). The plug is pushed in so that the unlocking-ring pushes the catches aside.

As the plug is pulled out its outer flange connects with the unlocking-ring and draws it backwards, preventing the catches from locking and allowing the plug to be fully withdrawn.

CEJN WEO SERIES

Plug - Straight Nipple For SAE 100R1/R2 Hose or Equivalent

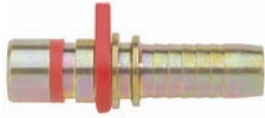

PART NO.	WEO PLUG-IN	LENGTH	HOSE CONNECTION	WORKING PRESSURE	PRICE
C147100403	1/4"	54.5 mm	3/16"	350 bar	£ 2.92
C147100404	1/4"	58.0 mm	1/4"	350 bar	£ 1.77
C147100604	3/8"	61.0 mm	1/4"	350 bar	£ 2.23
C147100605	3/8"	61.0 mm	5/16"	350 bar	£ 2.12
C147100606	3/8"	63.0 mm	3/8"	350 bar	£ 1.82
C147100806	1/2"	63.0 mm	3/8"	350 bar	£ 2.29
C147100808	1/2"	64.0 mm	1/2"	350 bar	£ 1.97
C147101208	3/4"	73.5 mm	1/2"	350 bar	£ 5.36
C147101210	3/4"	77.5 mm	5/8"	350 bar	£ 6.09
C147101212	3/4"	82.0 mm	3/4"	350 bar	£ 6.87
C147101616	1"	100.5 mm	1"	250 bar	£ 7.69

Plug - Straight Nipple For SAE 100R9R Multispiral Hose

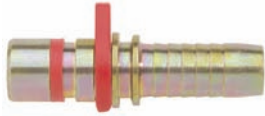

PART NO.	WEO PLUG-IN	LENGTH	HOSE CONNECTION	WORKING PRESSURE	PRICE
C147111212	3/4"	91.0 mm	3/4"	350 bar	£ 3.82
C147111616	1"	110.0 mm	1"	250 bar	£ 7.69

Plug - 45° Nipple For SAE 100R1/R2 Hose or Equivalent



PART NO.	WEO PLUG-IN	HOSE CONNECTION	WORKING PRESSURE	PRICE
C147120404	1/4"	1/4"	350 bar	£ 4.88
C147120604	3/8"	1/4"	350 bar	£ 5.92
C147120605	3/8"	5/16"	350 bar	£ 6.01
C147120606	3/8"	3/8"	350 bar	£ 5.27
C147120806	1/2"	3/8"	350 bar	£ 6.70
C147120808	1/2"	1/2"	350 bar	£ 6.96
C147121208	3/4"	1/2"	350 bar	£13.31
C147121210	3/4"	5/8"	350 bar	£14.00
C147121212	3/4"	3/4"	350 bar	£15.90

Plug - 45° Nipple For SAE 100R9R Multispiral Hose



PART NO.	WEO PLUG-IN	HOSE CONNECTION	WORKING PRESSURE	PRICE
C147131212	3/4"	3/4"	350 bar	£17.37

Plug - 90° Nipple For SAE 100R1/R2 Hose or Equivalent

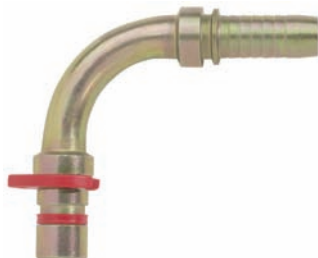

PART NO.	WEO PLUG-IN	HOSE CONNECTION	WORKING PRESSURE	PRICE
C147140404	1/4"	1/4"	350 bar	£ 5.32
C147140604	3/8"	1/4"	350 bar	£ 6.70
C147140605	3/8"	5/16"	350 bar	£ 6.87
C147140606	3/8"	3/8"	350 bar	£ 6.44
C147140806	1/2"	3/8"	350 bar	£ 7.82
C147140808	1/2"	1/2"	350 bar	£ 8.17
C147141208	3/4"	1/2"	350 bar	£15.82
C147141210	3/4"	5/8"	350 bar	£19.10
C147141212	3/4"	3/4"	350 bar	£20.31

Plug - 90° Nipple For SAE 100R9R Multispiral Hose



PART NO.	WEO PLUG-IN	HOSE CONNECTION	WORKING PRESSURE	PRICE
C147151212	3/4"	3/4"	350 bar	£21.00

CEJN WEO SERIES
Stop Plug



PART NO.	WEO PLUG-IN	LENGTH	WORKING PRESSURE	PRICE
C147230400	1/4"	43.0 mm	350 bar	£ 6.70
C147230600	3/8"	50.0 mm	350 bar	£ 7.74
C147230800	1/2"	50.0 mm	350 bar	£ 7.99
C147231200	3/4"	59.0 mm	350 bar	£11.75
C147231600	1"	75.0 mm	250 bar	£17.55

Socket - External G-Thread

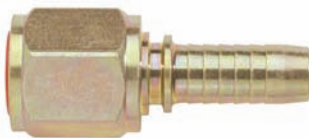

PART NO.	WEO PLUG-IN	LENGTH	CONNECTION BSPP	WORKING PRESSURE	PRICE
C148100404	1/4"	38.0 mm	1/4"	350 bar	£ 5.66
C148100606	3/8"	41.0 mm	3/8"	350 bar	£ 6.31
C148100808	1/2"	43.0 mm	1/2"	350 bar	£ 7.00
C148101212	3/4"	56.0 mm	3/4"	350 bar	£18.58
C148101616	1"	67.0 mm	1"	250 bar	£30.25

Stop Socket

PART NO.	WEO PLUG-IN	LENGTH	WORKING PRESSURE	PRICE
C148110400	1/4"	28.0 mm	350 bar	£ 6.78
C148110600	3/8"	31.0 mm	350 bar	£ 7.52
C148110800	1/2"	32.0 mm	350 bar	£ 8.47
C148111200	3/4"	44.0 mm	350 bar	£18.58
C148111600	1"	55.0 mm	250 bar	£28.44

Socket - Straight Nipple For SAE 100R1/R2 Hose or Equivalent

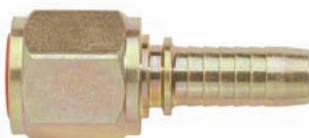
PART NO.	WEO PLUG-IN	LENGTH	HOSE CONNECTION	WORKING PRESSURE	PRICE
C148170404	1/4"	62.0 mm	1/4"	350 bar	£ 9.77
C148170606	3/8"	66.0 mm	3/8"	350 bar	£12.27
C148170808	1/2"	67.0 mm	1/2"	350 bar	£13.92
C148171212	3/4"	87.0 mm	3/4"	350 bar	£21.18
C148171616	1"	105.0 mm	1"	250 bar	£33.10

Socket - Straight Nipple For SAE 100R9R Multispiral Hose

PART NO.	WEO PLUG-IN	LENGTH	HOSE CONNECTION	WORKING PRESSURE	PRICE
C148181212	3/4"	95.0 mm	3/4"	350 bar	£21.18
C148181616	1"	115.0 mm	1"	250 bar	£33.10

Socket - SAE J514 O-Ring Boss



PART NO.	WEO PLUG-IN	LENGTH	CONNECTION UNF/UN	WORKING PRESSURE	PRICE
C148260407	1/4"	35.0 mm	7/16" - 20	350 bar	£ 6.78
C148260609	3/8"	39.0 mm	9/16" - 18	350 bar	£ 7.65
C148260812	1/2"	40.0 mm	3/4" - 16	350 bar	£ 8.30
C148260814	1/2"	41.6 mm	7/8" - 14	350 bar	£8.38
C148260817	1/2"	44.0 mm	1.1/16" - 12	350 bar	£8.56
C148261217	3/4"	55.0 mm	1.1/16" - 12	350 bar	£19.01
C148261621	1"	64.0 mm	1.5/16" - 12	350 bar	£31.03

Socket - External G-Thread with Integral Rubber Seal

PART NO.	WEO PLUG-IN	LENGTH	CONNECTION BSPP	WORKING PRESSURE	PRICE
C148300404	1/4"	38.0 mm	1/4"	350 bar	£ 6.18
C148300606	3/8"	41.0 mm	3/8"	350 bar	£ 6.78
C148300808	1/2"	43.0 mm	1/2"	350 bar	£ 7.52
C148301212	3/4"	56.0 mm	3/4"	350 bar	£18.93
C148301616	1"	69.0 mm	1"	250 bar	£30.68

CEJN WEO SERIES

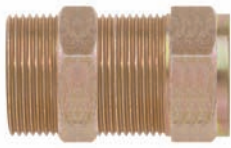
Socket - Bulkhead



PART NO.	WEO PLUG-IN	LENGTH	CONNECTION	WORKING PRESSURE	PRICE
C148130444	1/4"	42.0 mm	M 21.5 x 1.5	350 bar	£16.68
C148130646	3/8"	49.0 mm	M 26 x 1.5	350 bar	£18.15
C148130848	1/2"	49.0 mm	M 27 x 1.5	350 bar	£19.45

Plug-In Cartridge



PART NO.	WEO PLUG-IN	CONNECTION	WORKING PRESSURE	PRICE
C148000400	DN6	M 18 x 1.5	350 bar	£ 3.75
C148000600	DN10	M 22 x 1.5	350 bar	£ 4.10
C148000800	DN12	M 25 x 1.5	350 bar	£ 4.33

Ferrule



PART NO.	HOSE SIZE	TO SUIT HOSE	PRICE
C146400303	3/16"	SAE 100 R1AT/R2AT	£ 2.30
C146401704	1/4"	SAE 100 R1AT/R2AT	£ 1.87
C146401705	5/16"	SAE 100 R1AT/R2AT	£ 1.98
C146401706	3/8"	SAE 100 R1AT/R2AT	£ 1.59
C146401708	1/2"	SAE 100 R1AT/R2AT	£ 2.03
C146401710	5/8"	SAE 100 R1AT/R2AT	£ 2.91
C146401712	3/4"	SAE 100 R1AT/R2AT	£ 3.68
C146401716	1"	SAE 100 R1AT/R2AT	£ 6.67

FERRULES AVAILABLE FOR OTHER HOSES

